

General notes

All setting out must be checked on site  
All levels must be checked on site and refer to  
Ordnance Datum Newlyn unless alternative Datum given  
All fixings and weatherings must be checked on site  
All dimensions must be checked on site  
This drawing must not be scaled  
This drawing must be read in conjunction with all other  
relevant drawings, specification clauses and current design risk  
register  
This drawing must not be used for land transfer purposes  
Calculated areas in accordance with Assael Architecture's  
Definition of Areas for Schedule of Areas  
This drawing must not be used on site unless issued for  
construction  
Subject to survey, consultation and approval from all statutory  
Authorities

Revision Status:  
P=Preliminary  
C=Contract

© 2017 Assael Architecture Limited

Assael Architecture Limited has prepared this document in  
accordance with the instructions of the Client under the agreed  
Terms of Appointment. This document is for the sole and specific  
use of the Client and Assael Architecture shall not be responsible  
for any use of its contents for any purpose other than that for  
which it was prepared and provided. Should the Client require to  
pass electronic copies of the document to other parties, this  
should be for co-ordination purposes only, the whole of the file  
should be so copied, but no professional liability or warranty shall  
be extended to other parties by Assael Architecture in this  
connection without the explicit written agreement thereto by  
Assael Architecture Limited.

Drawing notes

Electronic file reference

A2874 Eynsham Drive Plans Working

Status R:	Revision	Date	DRN	CHK	CDM
20	Planning Addendum	19/09/18	CS	ES	

Application boundary

Purpose of information

The purpose of the information on this drawing is for:

- Planning ☐  
Information ☒  
Comment ☐  
Client approval ☐  
Construction ☐

All information on this drawing is not  
for construction unless it is marked  
for construction.

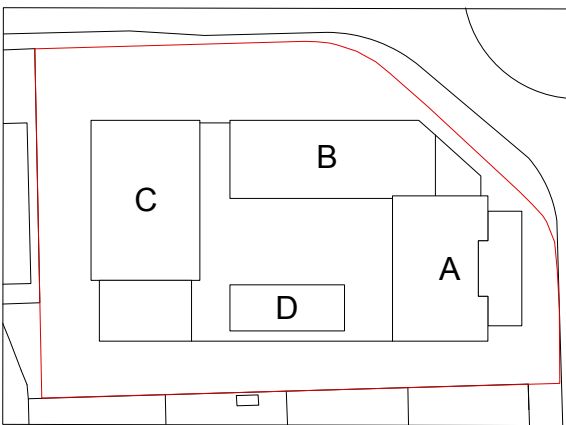

Client

Abbey Wood  
Property Ltd

Project title

Eynsham Drive  
Abbey Wood

Drawing title

Proposed Plan  
Sixteenth Floor

Scale @ A1 size Date

1:200 Feb '17

Drawing N° Status & Revision

A2874 216 R20

Assael

Assael Architecture Limited  
123 Upper Richmond Road  
London SW15 2TL

+44 (0)20 7736 7744  
info@assael.co.uk  
www.assael.co.uk